

LOGEMENT TYPE F3 B

01	HALL	14.36 M ²
02	SÉJOUR	20.05 M ²
03	CHAMBRE 01	17.12 M ²
04	CHAMBRE 02	18.58 M ²
05	CUISINE	14.34 M ²
06	SDB	05.20 M ²
07	WC	01.60 M ²
08	BALCON	14.10 M ²

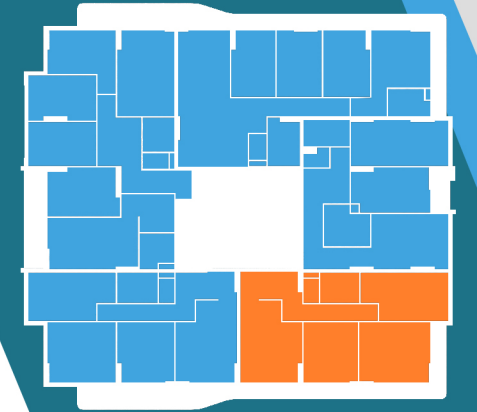

SURFACE PRIVATIVE : 95.57 M²

SURFACE COMMUNE A USAGE PRIVATIVE : 14.10 M²